

Varsity

2022 Q2 Stats

Varsity Total Area

DETACHED



April - June
2021

April - June
2022

| | | |
|-------------------------------|-----------|-----------|
| Total Sales | 47 | 36 |
| *Average Sold Price / Sq. Ft. | \$455 | \$535 |
| Average Sold Price | \$748,497 | \$888,019 |
| Average Days On Market | 26 | 19 |

SEMI DETACHED/ROW



| | | |
|-------------------------------|-----------|-----------|
| Total Sales | 26 | 24 |
| *Average Sold Price / Sq. Ft. | \$308 | \$315 |
| Average Sold Price | \$374,992 | \$438,050 |
| Average Days On Market | 41 | 19 |

APARTMENT



| | | |
|-------------------------------|-----------|-----------|
| Total Sales | 25 | 43 |
| *Average Sold Price / Sq. Ft. | \$321 | \$303 |
| Average Sold Price | \$257,420 | \$261,164 |
| Average Days On Market | 59 | 50 |

Data based on listings from CREB MLS from March 18 - June 24, 2021 vs 2022. Information deemed accurate but not guaranteed. *Bungalows that may be included may skew these stats.

Livia McCabe/Brendan Hughes

Top Producers and longtime Varsity residents

403.542.1112/403.560.1673

www.mccabehughes.com



Varsity

2022 Q2 Stats

By Geographical Area

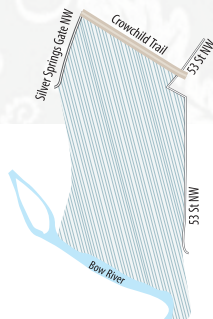

APR-JUNE
2021

APR-JUNE
2022

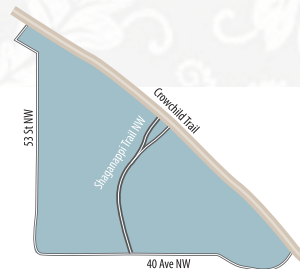

APR-JUNE
2021

APR-JUNE
2022

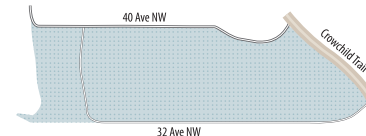

APR-JUNE
2021

APR-JUNE
2022

| DETACHED | | | | | | |
|-------------------------------|-----------|-------------|-----------|-----------|-----------|-----------|
| Total Sales | 12 | 11 | 29 | 21 | 6 | 4 |
| *Average Sold Price / Sq. Ft. | \$381 | \$514 | \$495 | \$567 | \$414 | \$424 |
| Average Sold Price | \$983,333 | \$1,202,364 | \$651,736 | \$734,176 | \$746,508 | \$831,250 |
| Average Days On Market | 25 | 18 | 24 | 20 | 35 | 20 |
| SEMI-DETACHED/ROW | | | | | | |
| Total Sales | 3 | 5 | 14 | 8 | 9 | 11 |
| *Average Sold Price / Sq. Ft. | \$359 | \$348 | \$325 | \$338 | \$266 | \$283 |
| Average Sold Price | \$566,967 | \$577,160 | \$318,107 | \$315,988 | \$399,489 | \$463,591 |
| Average Days On Market | 33 | 11 | 45 | 19 | 38 | 23 |
| APARTMENT | | | | | | |
| Total Sales | N/A | N/A | 8 | 12 | 17 | 31 |
| Average Sold Price / Sq. Ft. | N/A | N/A | \$349 | \$350 | \$308 | \$386 |
| Average Sold Price | N/A | N/A | \$358,500 | \$335,442 | \$209,853 | \$232,411 |
| Average Days On Market | N/A | N/A | 90 | 59 | 44 | 31 |

Data based on listings from CREB MLS from March 18 - June 24, 2021 vs 2022. Information deemed accurate but not guaranteed. *Bungalows that may be included may skew these stats.



If you are looking to sell please call Livia McCabe/Brendan Hughes
403.542.1112/403.560.1673 ~ www.mccabehughes.com



*Not intended to cause or induce breach of an existing agency agreement.

